

Innovafit® CLAMPS

FOR BIOPHARMA USE



New design represents a new generation of clamping technology for the pharmaceutical industry. They feature an outer body with no sharp edges, eliminating the potential for snags, scratches and punctures.

Bio-Pharma



Innovafit® Clamps

Innovafit® Mid and Large Tube Clamps provide innovative clamping technology and are designed to accommodate large diameter and thick wall tubing applications. It is compatible with standard, braided (reinforced) and multi layer tubing. In addition to providing complete fluid stoppage, Innovafit® Clamps can be utilized in the flow position and features an integral bore hole for absolute lock-out capabilities.

Features

- Complete fluid stoppage
- Smooth edges and corners
- All materials animal derivative-free
- Autoclavable and sterilizable (autoclave not recommended for polypropylene clamps)

Material

Nylon 66 with GF filled

Applications

- Drug delivery
- Pharmaceutical processes
- Media process systems
- Sterile bag systems
- Aseptic fluid transport
- Bioreactors and fermentor
- Laboratory functions



+86 (0)512 58637230
+86 17317862507



info@innovapure.com
www.innovapure.com



Innovation Park, Lekun Road
Zhangjiagang, Suzhou, China

Innovafit® Clamps Typical Physical Properties

Physical Properties	Test Method	Unit	Typical Value
Color	-		White
Hardness (Shore D)	ASTM D2240		72
Max working temperature		C	90
UV resistance			Excellent
Moisture absorption	ASTM D570-81	%	0.01
Tensile strength	ASTM D638-91	Mpa	33

Innovafit® Clamps Selection Guide

Specification	Value
Parts #	TCS079X238PPAF
Materials	Polypropylene with GF filled
Minimum wall thickness	0.79mm 1/32 Inch
Maximum wall thickness	2.38mm 3/32 Inch
Maximum tubing O.D.	12.70mm 1/2 Inch

Specification	Value
Parts #	TCM318X635PPAF
Materials	Polypropylene with GF filled
Minimum wall thickness	3.18mm 1/8 Inch
Maximum wall thickness	6.35mm 1/4 Inch
Maximum tubing O.D.	25.40mm 1 Inch

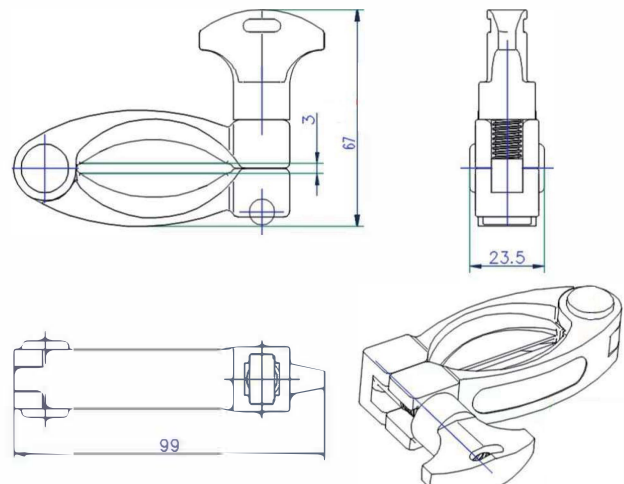
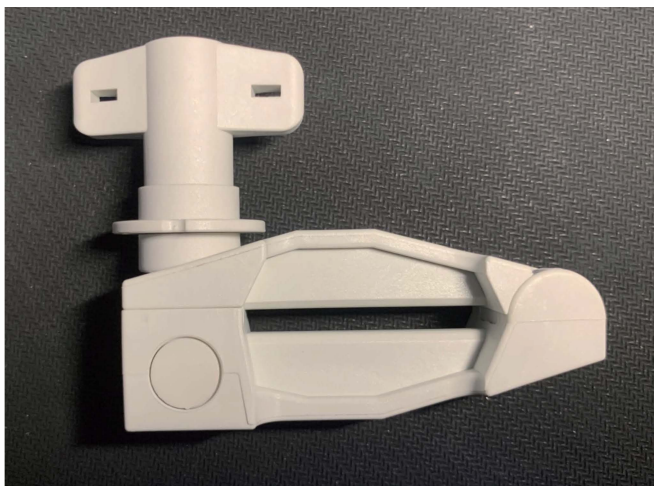

More information of Innovafit® Clamps is available on www.innovapure.com or call Innovapure sales representative.



Important

It is the user's responsibility to ensure the suitability and safety of Suzhou Innovapure Co., Ltd. products for all intended uses. Laboratory and clinical tests must be conducted in accordance with applicable regulatory requirements in order to determine the safety and effectiveness for use of tubing in any particular application.